

3102-30 – ‘Royale’ Towel Bar 30”

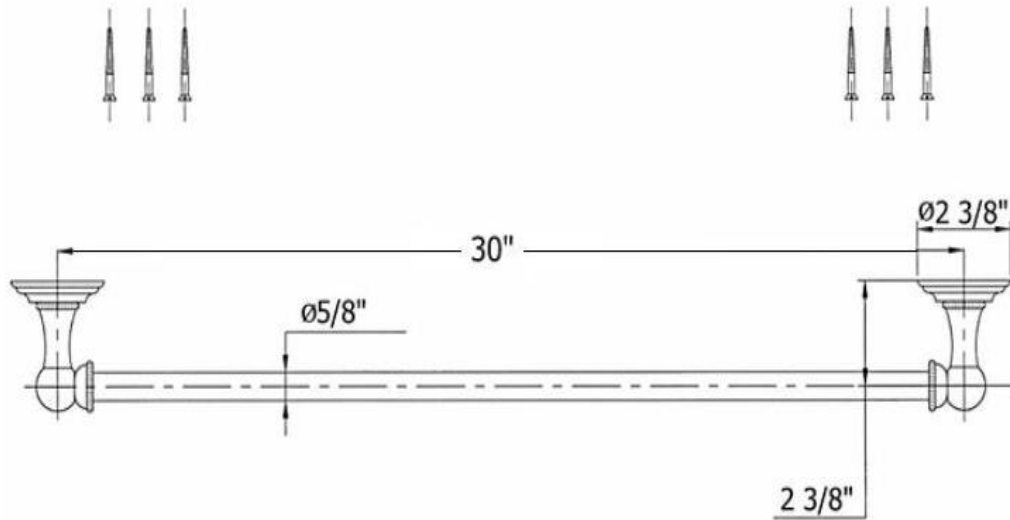

Technical Information

- Bar can be cut to size.
- Available finishes are French Weathered Brass (47), Polished Chrome (48), SoliBrass (49), Lacquered Matte Black Nickel (50), Old Gold (52), Old Silver (53), Polished Brass (55), Polished Nickel (56), Brushed Nickel (57), Satin Nickel (60), Antique Lacquered Copper (67), Antique Lacquered Brass (68), Weathered Brass (70), Lacquered Polished Black Nickel (71) and Lacquered Polished Copper (80).
- Please See Cleaning Instructions: <http://herbeau.com/CleaningAll.pdf> For Finish Care and Maintenance Information.

Part#

01
02
03
04
05
06
07
08
09

Description

Mounting Plate
Escutcheon
Connection For Escutcheon
Right Side Bracket
Set Screw
Coupling For Slide Bar
30” Towel Bar Only
Mounting Screw Kit
Left Side Bracket

Please follow example when ordering parts for ‘Royale’ Towel Bar 30”

- To order part#02 – Wall Escutcheon
 - 950070xx
- Please substitute finish number needed in place of **XX**



Herbeau[®]
L'Art du Sanitaire depuis 1857

3102-30 - 'Royale' Towel Bar 30"

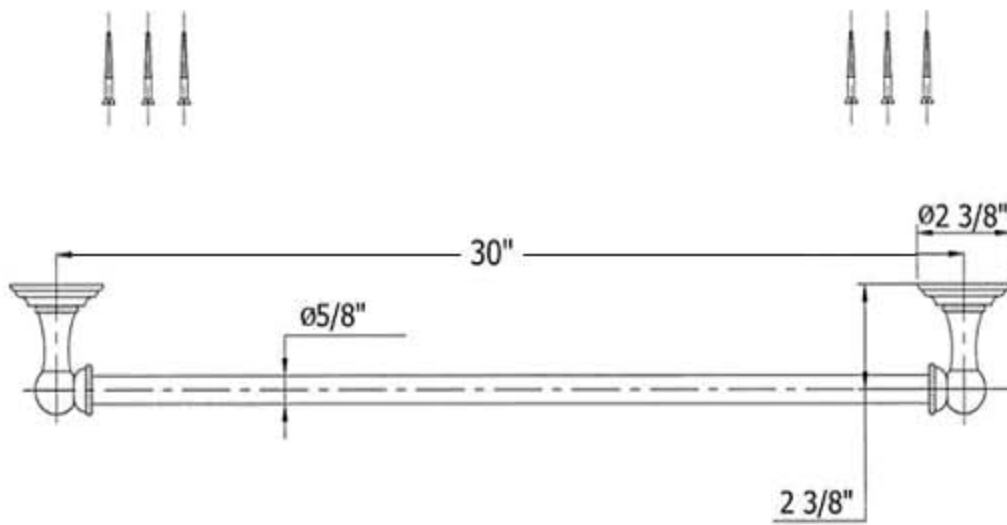

3102-30 - 'Royale' Towel Bar 30"

*P/N = PART NUMBER

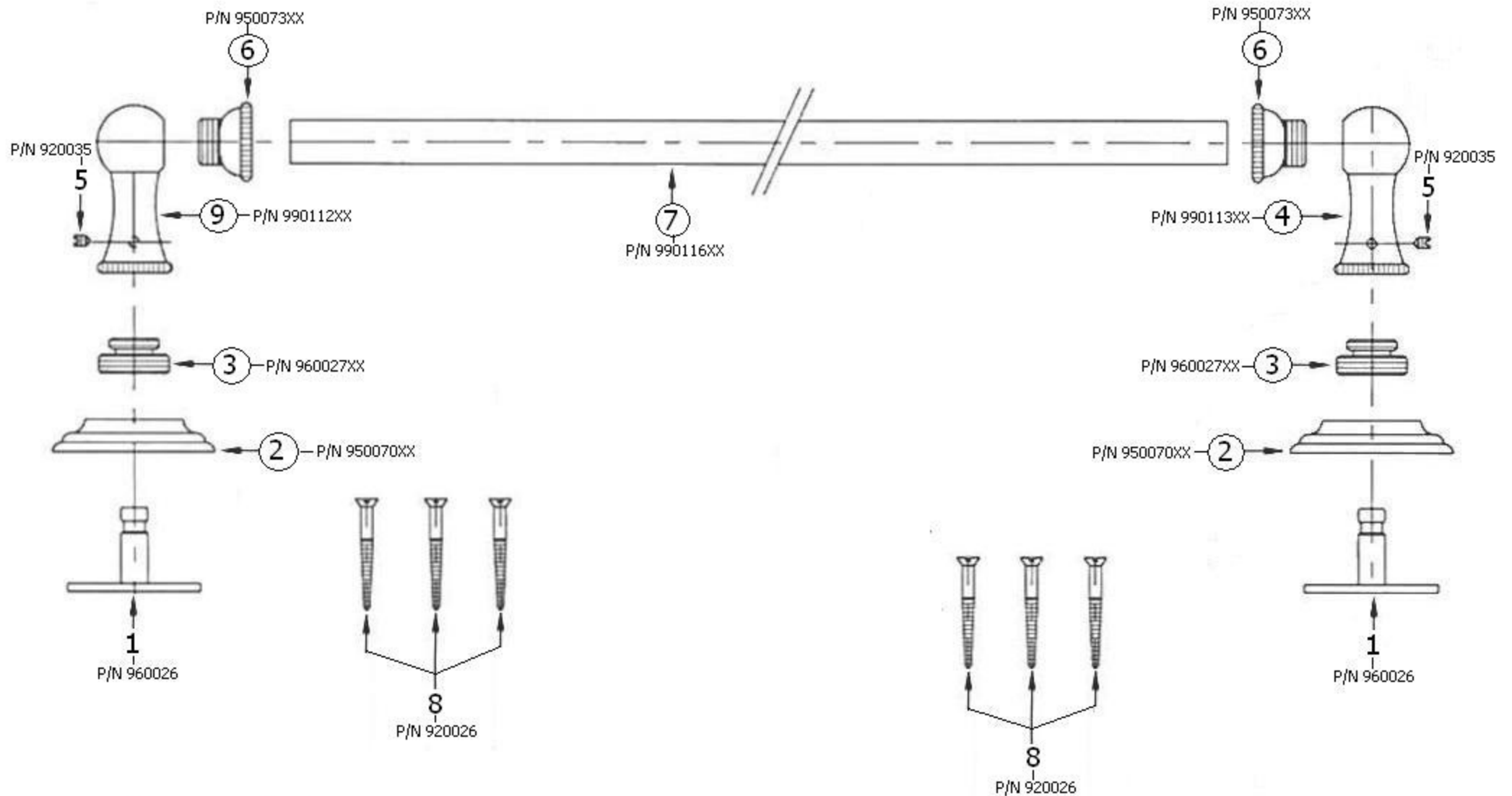

○ = FINISHED PARTS

XX = TWO DIGIT FINISH CODE